

# **ST1100**

# **POLICE**

**OWNER'S MANUAL**

**HONDA**

**ST1100 • 1995**



**HONDA**

**ST1100 POLICE**

**OWNER'S MANUAL**

**MANUAL DEL PROPIETARIO**

**INSTRUKTIEBOEK**

**MANUEL DU CONDUCTEUR**

**FAHRER-HANDBUCH**

---

## IMPORTANT NOTICE

- **OPERATOR ONLY. NO PASSENGER**

This motorcycle is designed and constructed as an operator-only model. The seating configuration does not safely permit the carrying of a passenger. Never exceed the maximum weight capacity as shown on the tyre information label.

- **ON-ROAD USE**

This motorcycle is designed to be used only on the road.

- **READ THIS OWNER'S MANUAL CAREFULLY**

Pay special attention to statements preceded by the following words:

**▲ WARNING**

*Indicates a strong possibility of severe personal injury or death if instructions are not followed.*

**CAUTION:**

*Indicates a possibility of personal injury or equipment damage if instructions are not followed.*

NOTE: Gives helpful information.

This manual should be considered a permanent part of the motorcycle and should remain with the motorcycle when resold.

---

**HONDA ST1100 POLICE  
OWNER'S MANUAL**

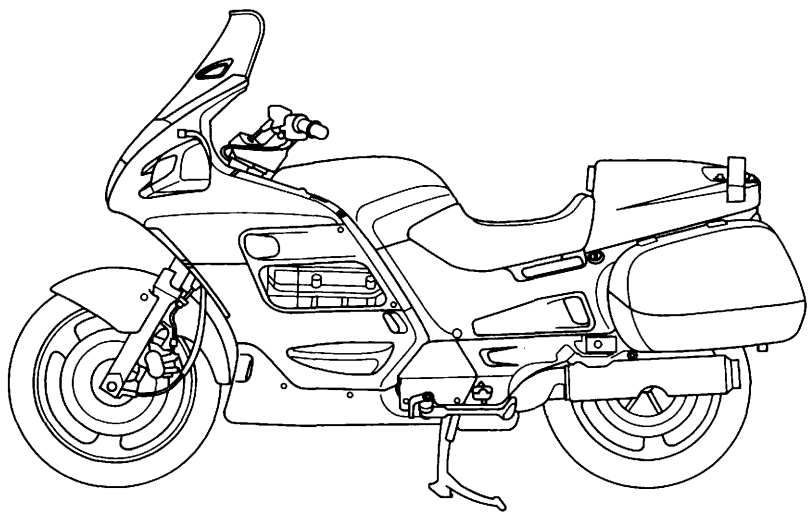

***All information in this publication is based on the latest production information available at the time of approval for printing. HONDA MOTOR CO., LTD. reserves the right to make changes at any time without notice and without incurring any obligation. No part of this publication may be reproduced without written permission.***

# WELCOME

---

This manual covers information on the Honda ST1100 Police. For information not shown in this manual, refer to the Honda "Pan European" Owner's Manual.

Unlike an automobile, there is no metal cage around you. Like an airplane, a preride inspection and regular maintenance are essential to your safety. Your reward is freedom.

To meet the challenges safely, and to enjoy the adventure fully, you should become thoroughly familiar with this owner's manual BEFORE YOU RIDE THE MOTORCYCLE.

When service is required, remember that your Honda dealer knows your motorcycle best. If you have the required mechanical "know-how" and tools, your dealer can supply you with an official Honda Service Manual to help you perform many maintenance and repair tasks.

Pleasant riding, and thank you for choosing a Honda!

- Following codes in this manual indicate each country.

E	UK
ED	European direct sales Holland Belgium Portugal
SP	Spain
AR	Austria
U	Australia

- The specifications may vary with each local.

# CONTENTS

---

## OPERATION

### Page

- 1 MOTORCYCLE SAFETY
  - 1 Loading and Accessories
  
- 3 PARTS LOCATION
  - 6 Voltmeter
  
- 7 ESSENTIAL INDIVIDUAL COMPONENTS
  - 7 Right Handlebar Controls
  - 9 Hazard Switch
  
- 10 FEATURES (Not required for operation)
  - 10 Seat
  - 11 Document Compartment

## MAINTENANCE

### Page

- 12 ELECTRICAL
  - 12 Fuse Replacement
  - 13 Bulb Replacement
  
- 16 SPECIFICATIONS





# MOTORCYCLE SAFETY

---

## LOADING AND ACCESSORIES

### **▲ WARNING**

- *To prevent an accident, use extreme care when adding and riding with accessories and cargo. Addition of accessories and cargo can reduce a motorcycle's stability, performance and safe operating speed. Never ride an accessory-equipped motorcycle at speeds above 130 km (80 mph). And remember that this 130 km (80 mph) limit may be reduced by installation of non-Honda accessories, improper loading, worn tires and overall motorcycle condition, poor road or weather conditions. These general guidelines may help you decide whether or how to equip your motorcycle, and how to load it safely.*

### **Loading**

The combined weight of the rider, cargo and additional accessories must not exceed 195 kg (430 lbs), the maximum weight capacity. Cargo weight alone should not exceed 18 kg (40 lbs).

1. Keep cargo and accessory weight low and close to the center of the motorcycle. Load weight equally on both sides to minimize imbalance. As weight is located farther from the motorcycle's center of gravity, handling is proportionally affected.
2. Adjust tire pressure.
3. All cargo and accessories must be secure for stable handling. Recheck cargo security and accessory mounts frequently.

# MOTORCYCLE SAFETY

---

4. Do not attach large, heavy items to the handlebars, fork, or fender. Unstable handling or slow steering response may result.
5. Do not exceed the maximum weight capacity of Honda accessories.
  - Saddlebag: 9 kg (20 lbs) Each side
  - Fairing pocket: 2 kg (4.5 lbs) Each side
6. The Honda fairing and saddlebag are designed for this motorcycle only. Do not install them on any other motorcycle.
7. Do not store articles between fairing and motorcycle. They may interfere with steering causing loss of control.
8. Do not use the handlebars to hold the motorcycle with a rope during transportation or the handlebars may be bent.

## Accessories

Genuine Honda accessories have been specifically designed for and tested on this motorcycle. Because the factory cannot test all other accessories, you are personally responsible for proper selection, installation, and use of non-Honda accessories.

Always follow the guidelines under Loading, and these:

1. Carefully inspect the accessory to make sure it does not obscure any lights, reduce ground clearance and banking angle, or limit suspension travel, steering travel or control operation.
2. Large fork-mounted fairings or windshields, or poorly designed or improperly mounted fairings can produce aerodynamic forces that cause unstable handling. Do not install fairings that decrease cooling air flow to the engine.

# PARTS LOCATION

---

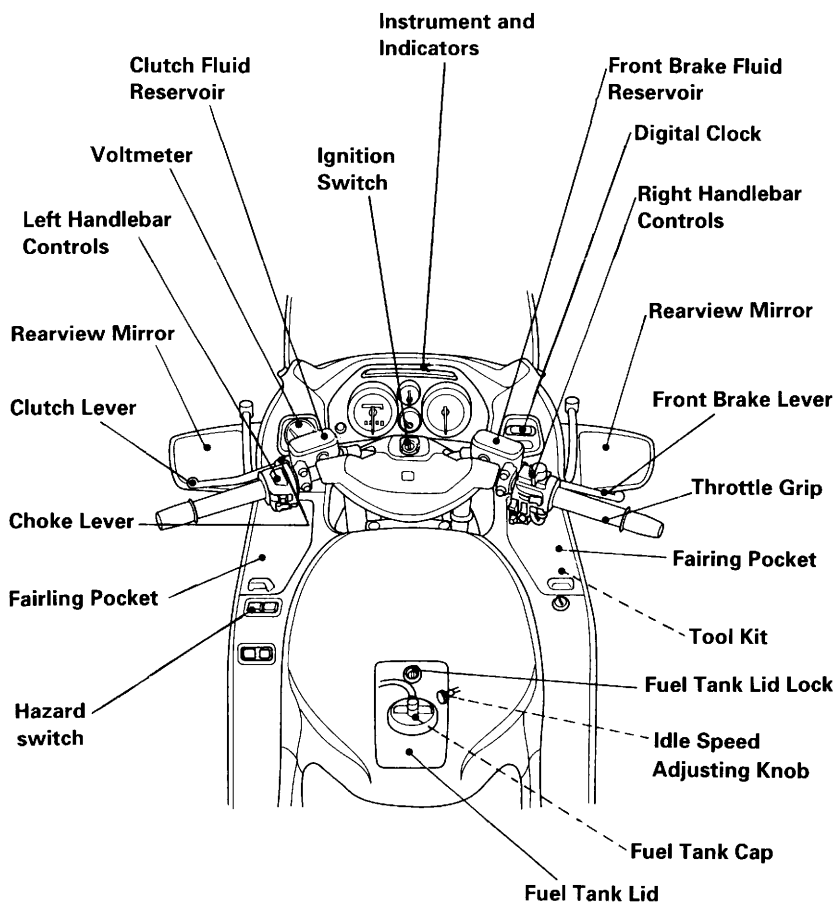

# PARTS LOCATION

---

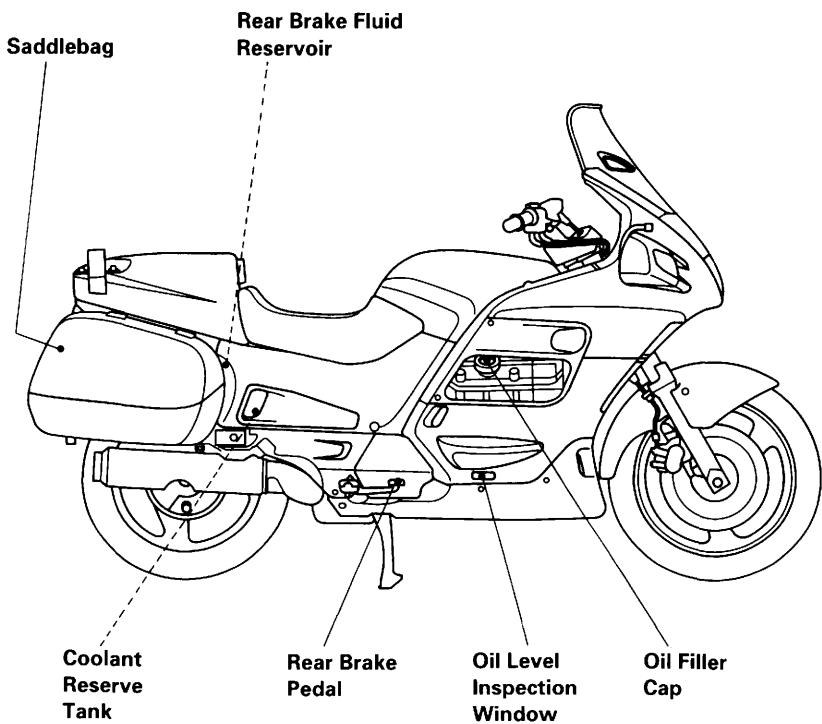

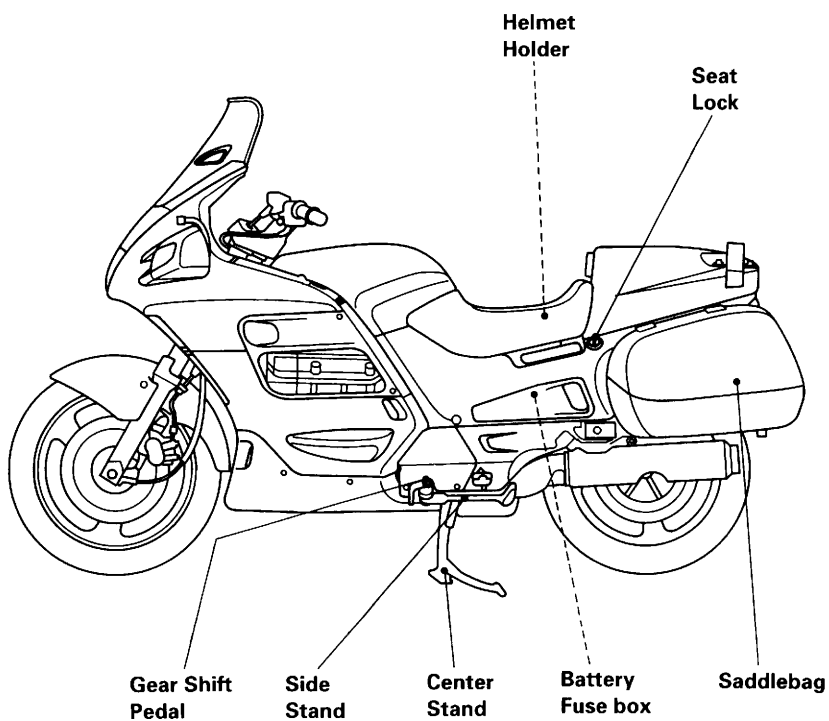

# PARTS LOCATION

---

## Voltmeter

This meter shows you the battery voltage when the ignition is ON.

The needle should stay within the white zone.

If the needle reaches the red zone, immediately turn off the lighting and other electrical circuits to reduce load on the battery.

### CAUTION:

- ***Damage to the battery may result if the needle allowed to stay within the red zone.***

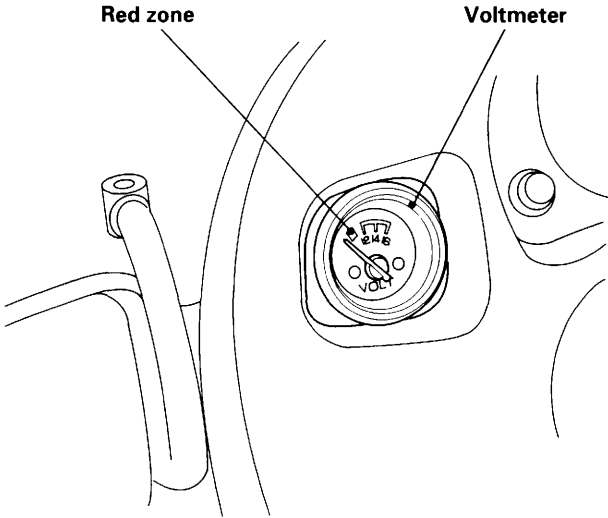

# ESSENTIAL INDIVIDUAL COMPONENTS

---

## RIGHT HANDLEBAR CONTROLS

### Engine Stop Switch

The engine stop switch is next to the throttle grip. When the switch is in the RUN position, the engine will operate. When the switch is in the OFF position, the engine will not operate. This switch is intended primarily as a safety or emergency switch and should normally remain in the RUN position.

#### NOTE:

- If your motorcycle is stopped with the ignition switch ON and the engine stop switch OFF, the headlight and taillight will still be on, resulting in battery discharge.

### Starter Button

The starter button is below the engine stop switch. When the starter button is pressed, the starter motor will crank the engine.

### Headlight Switch (Except U type)

The headlight switch has three positions, "H", "P" and "OFF" marked by dot.

H: Headlight, taillight, position light and meter lights on.

P: Position light, taillight and meter lights on.

OFF (dot): Headlight, taillight, position light and meter lights off.

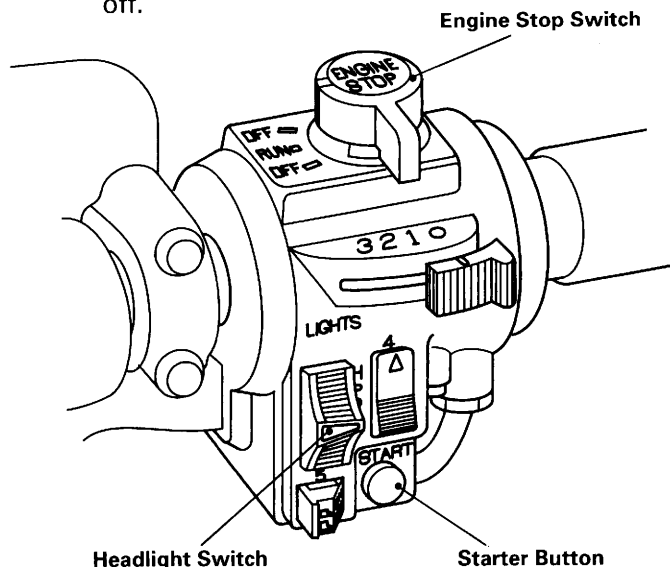

# ESSENTIAL INDIVIDUAL COMPONENTS

The ST1100 Police is equipped with five, seven; U type, electrical circuits for control of its accessories.

The circuits can be turned on and off by means of the three, four; U type, switches at the right handlebar.

Do not allow the load on the circuits to exceed the following limits when the headlight is in LOW.

## CAUTION:

- **Running the engine with the load in excess of the following limits may cause damage to the AC generator.**

### Max. Allowable Load

	Headlight (LOW)	Max. allowable load (Patrol lights, siren, etc.)
UK Spain Portugal	55 W × 2	90 W (Equivalent to 3 patrol lights)
Belgium Holland Austria	55 W × 1	145 W (Equivalent to 3 patrol lights + 55 W)
Australia	45 W × 2	110 W (Equivalent to 3 patrol lights + 20 W)

(Except U type)

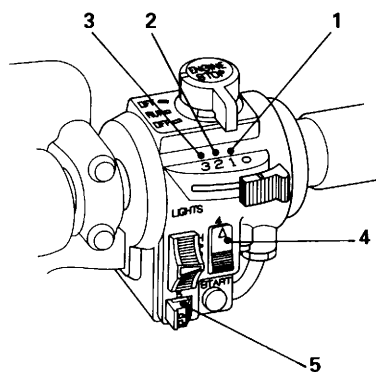

(U type)

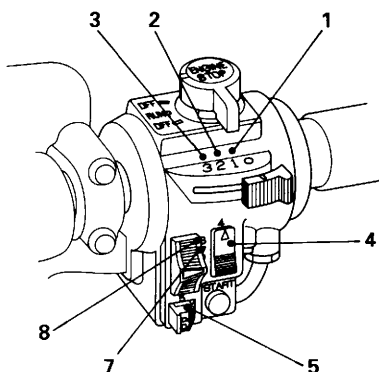



---

## Hazard Switch

The hazard switch is located under the left fairing pocket. It activates all outside signals (U type; Except headlight) regardless of position of the ignition switch.

### CAUTION:

- *The system should be used only when the motorcycle is stopped under emergency or hazardous condition.*
- *Be sure to turn the switch off when the hazard warning is no longer required. Activating the outside signals for longer than 30 minutes may discharge the battery, resulting in difficulty in starting the engine.*

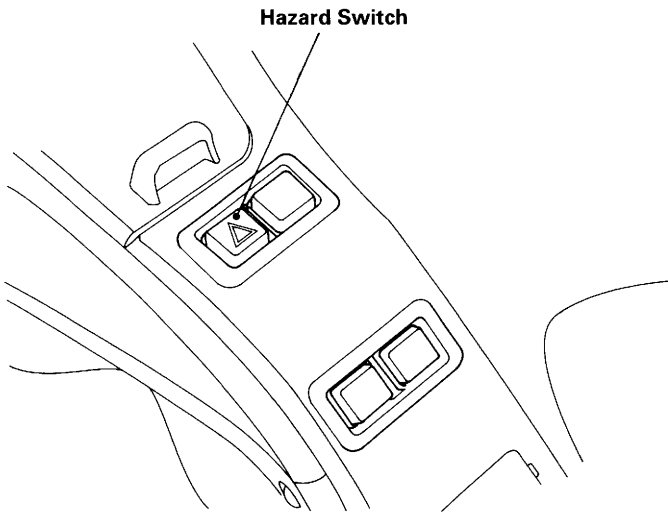

## FEATURES (Not required for operation)

---

### SEAT

To remove the seat, insert the ignition key into the lock and turn it clockwise.

### CAUTION:

- *Be sure to securely lock the seat after installing it.*

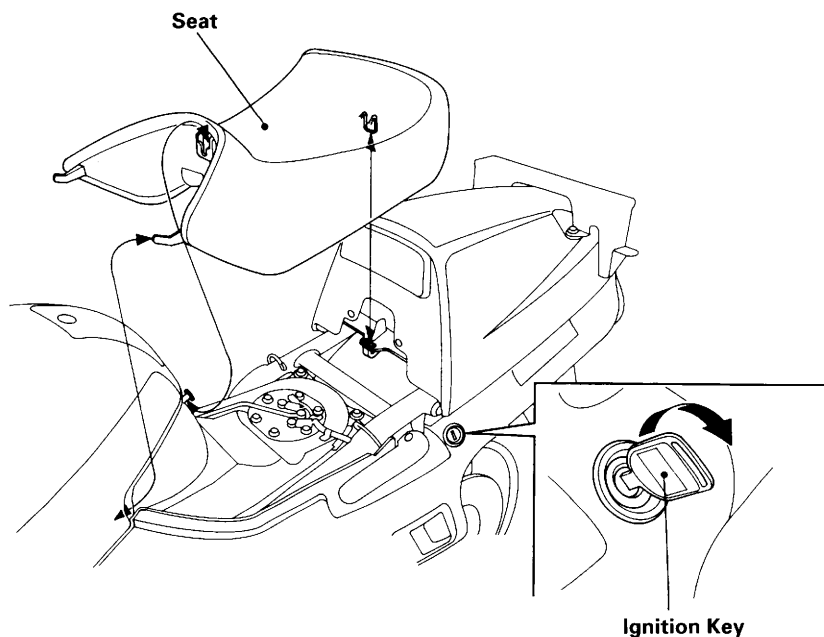

---

## DOCUMENT COMPARTMENT

The document compartment is in the saddlebags. The owners manual and other documents should be stored in the plastic bag.

### NOTE:

- When washing your motorcycle, be careful not to flood this area with water.

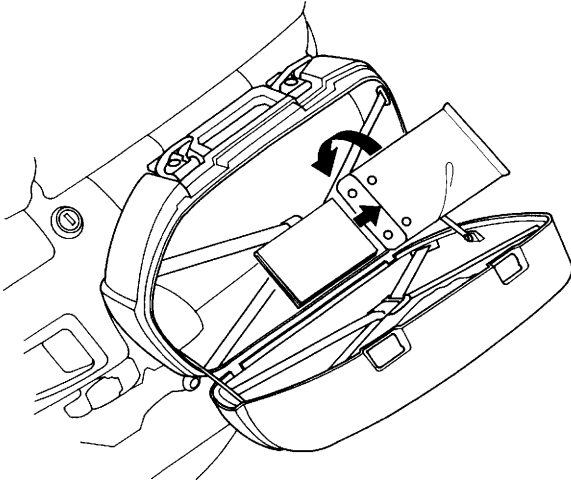

# ELECTRICAL

---

## FUSE REPLACEMENT

The fuse box is located under the left side cover.

The specified fuses are:

10A and 20A

When frequent fuse failure occurs, it usually indicates a short circuit or an overload in the electrical system. See your authorized Honda dealer for repair.

### CAUTION:

- **Turn the ignition switch OFF before checking or replacing fuses to prevent accidental short-circuiting.**

To replace fuses in the fuse box: remove the left side cover. Pull the old fuse out of the clips. Push a new fuse into the clips and install the fuse box cover.

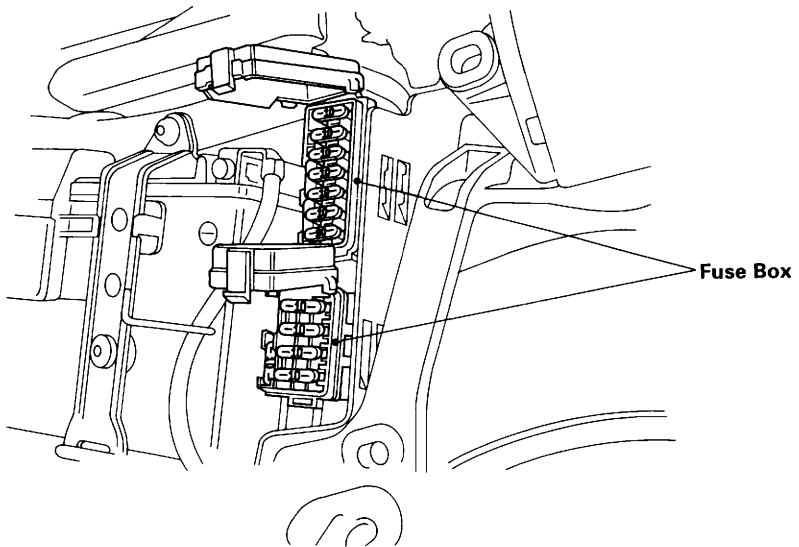

---

## BULB REPLACEMENT

### **⚠ WARNING**

- \* The light bulb becomes very hot while the light is ON, and remain hot for a while after it is turned OFF. Be sure to let it cool down before servicing.

### **CAUTION:**

- \* Wear clean gloves while replacing the bulb.
- \* If you touch the bulb with your bare hands, clean it with a cloth moistened with alcohol to prevent its early failure.

### **NOTE:**

- \* Be sure to turn the ignition switch OFF when replacing the bulb.

### **Tail/Brake light Bulb**

### **Rear Turn signal light Bulb**

1. Remove the seat (page 10).
2. Remove the saddlebags.
3. Remove the side covers.
4. Remove the two screws fastening the front of the seat cowl, then remove the four bolts while holding the stay by hand. Remove the seat cowl by pulling it up.

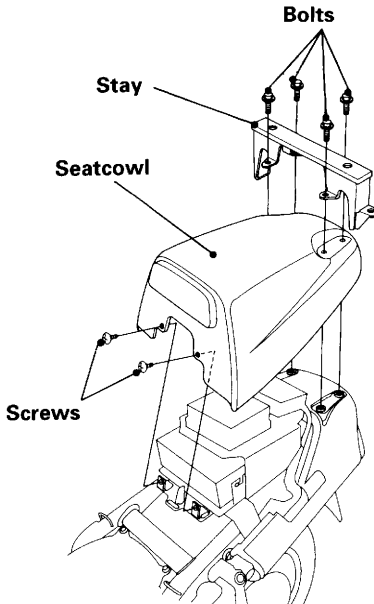

# ELECTRICAL

---

5. Turn the socket 90° counterclockwise, then pull it out toward you.
6. Slightly press down on the bulb and turn it counterclockwise.
7. Install a new bulb in the reverse order of removal.

## NOTE:

- \* Do not use bulbs other than that specified.
- \* After installing a new bulb, check that the light operates properly.

### <Tail/Brake light Bulb>

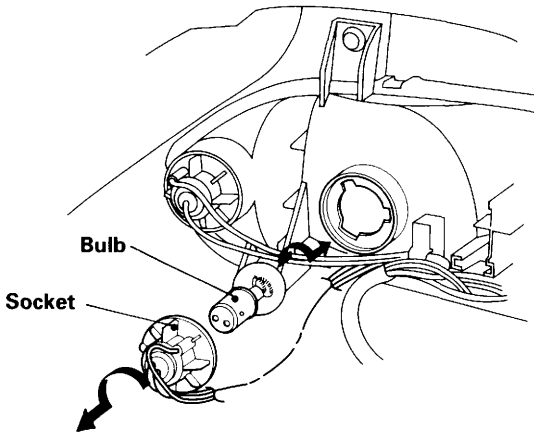

### <Rear Turn Signal Bulb>

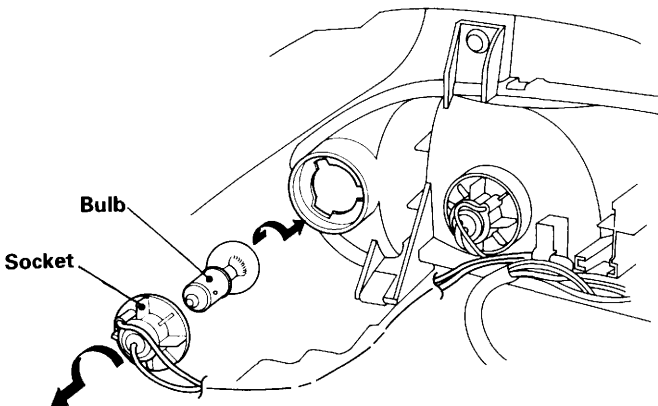

---

\* If a radio etc. is installed in the seat cowl, remove the rear cowl before replacing the bulb.

To remove:

- Remove the two bolts, then lift the rear cowl up.
- Unplug the connectors and remove the rear cowl.

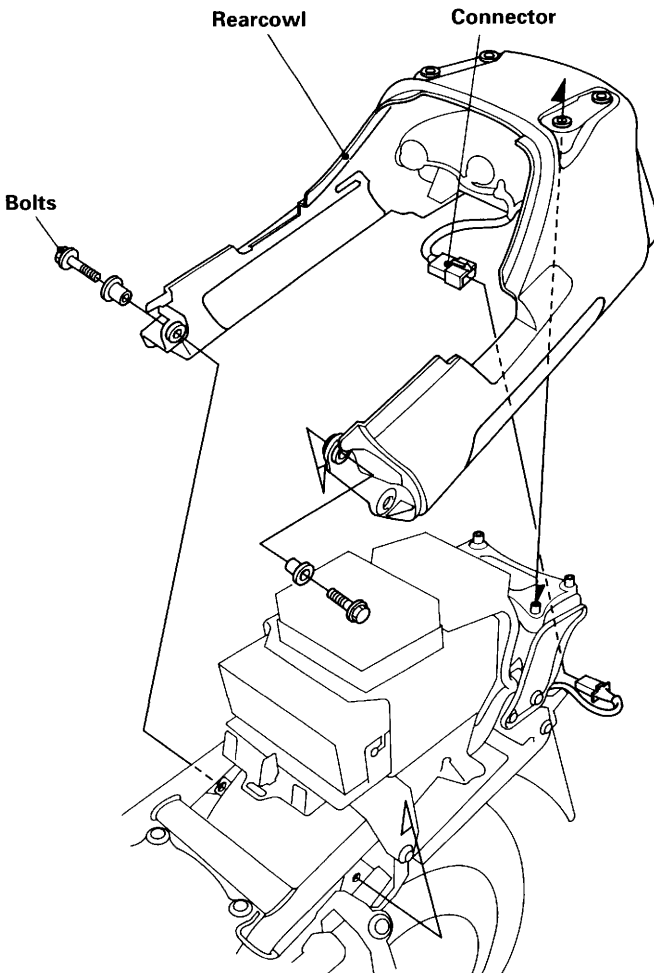

# SPECIFICATIONS

---

## DIMENSIONS

Overall length	2,285 mm (89.9 in)
Overall width	835 mm (32.9 in)
Overall height	1,405 mm (55.3 in)
Wheelbase	1,555 mm (61.2 in)
Ground clearance	145 mm (5.7 in)

## WEIGHT

Dry weight	293 kg (646 lbs)
------------	------------------

## CAPACITIES

Engine oil:	
After draining	3.6 ℓ (3.8 US qt, 3.2 Imp qt)
After oil filter change	3.7ℓ (3.9 US qt, 3.3 Imp qt)
After disassembly	4.3 ℓ (4.5 US qt, 3.8 Imp qt)
Final drive gear oil	150 cc (5.1 oz) After draining
Fuel tank	28 ℓ (7.4 US gal, 6.1 Imp gal)
Cooling system capacity	3.0 ℓ (0.79 US gal, 0.66 Imp gal)
Passenger capacity	Operator only, no passenger
Maximum weight capacity	195 <sup>kg</sup> (430 lb)

## ENGINE

Bore and stroke	73 × 64.8 mm (2.87 × 2.55 in)
Compression ratio	10 : 1
Displacement	1,084 cc (66.1 cu.in)
Spark plug	
Standard	U24FER9 (NIPPONDENSO), CR8EH9 (NGK)
For extended high speed riding	U27FER9 (NIPPONDENSO), CR9EH9 (NGK)
Spark plug gap	0.8—0.9 mm (0.031—0.035 in)
Idle speed	1,000 ± 100 rpm



---

## CHASSIS AND SUSPENSION

Caster	27.5°
Trail	101 mm (4.0 in)
Tire size, front	110/80V18 (DUNLOP, BRIDGESTONE) 110/80V18—V240 (METZELER) U type; BRIDGESTONE ONLY
Tire size, rear	160/70V17 (DUNLOP, BRIDGESTONE) 160/70VB17—V240 (METZELER) U type; BRIDGESTONE ONLY

## POWER TRANSMISSION

Primary reduction	1.8292
Gear ratio,	1st 2.2666
Gear ratio,	2nd 1.5000
Gear ratio,	3rd 1.1428
Gear ratio,	4th 0.9166
Gear ratio,	5th 0.7586
Final reduction	2.8333

## ELECTRICAL

Battery	12V—12AH
Generator	0.42 kw/5,000 rpm

## FUSES

Main fuse	30A
Other fuses	20A, 10A

## LIGHTS

Headlight	12V60/55W × 2 (Except U) 12V45/45W × 2 (U)
Tail/Brake light	12V5/21W × 2
Turn signal light	12V21W
Position light	12V5W (Except U)

---

**MEMO**